

SDX10 Bass Module Assembly Visuals

The following pages show the recommended order of panel assembly. Please check all mating surfaces for remaining saw dust from the manufacturing process and remove if necessary. Assemble each speaker fully without glue first to ensure proper fit before moving on to the glue-up phase.

This brace panel is not the same length in both dimensions. Be aware during assembly that it will only fit if in the proper orientation.

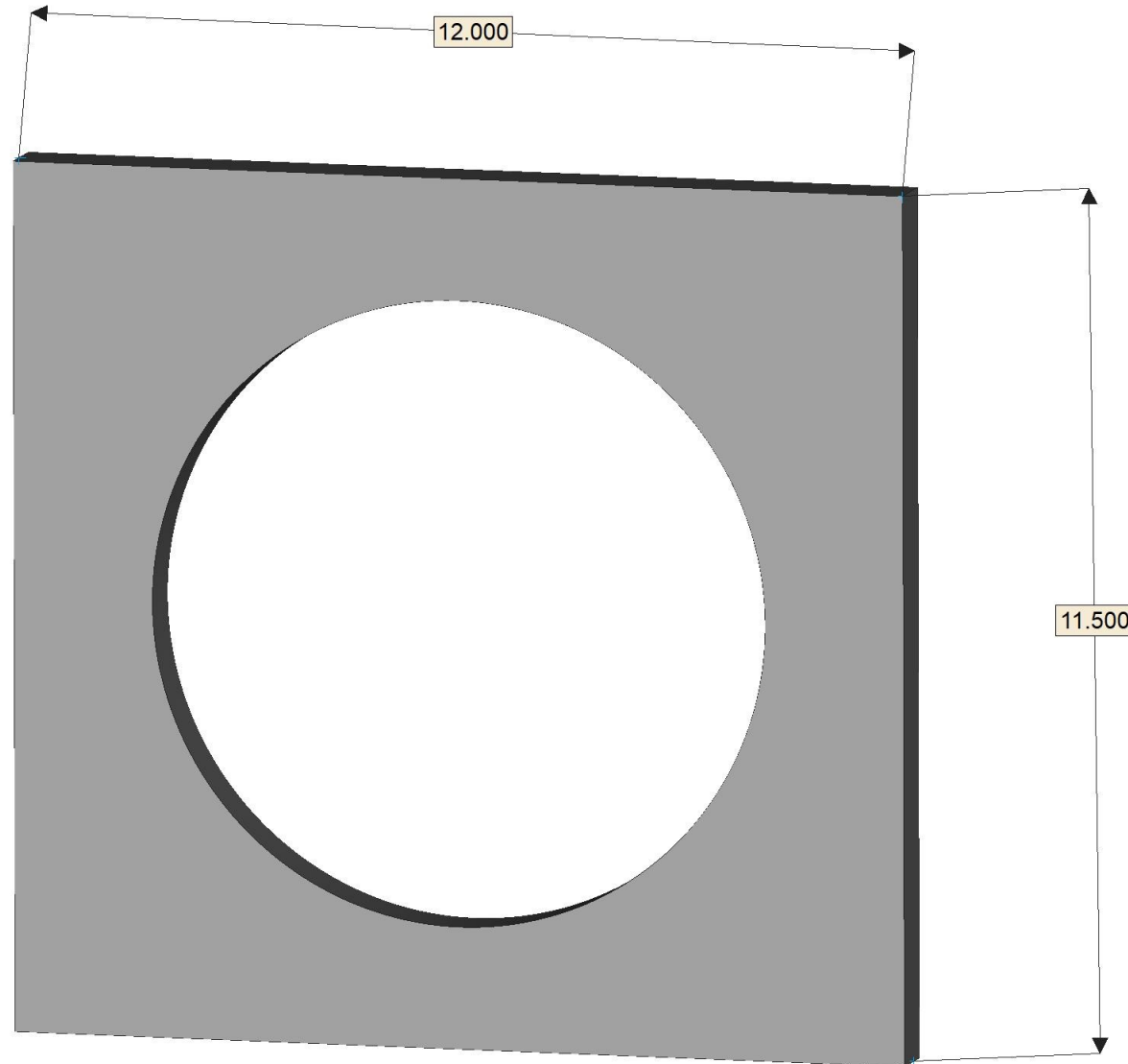

**Oblong holes should
be positioned
towards the rear of
the enclosure.**

